

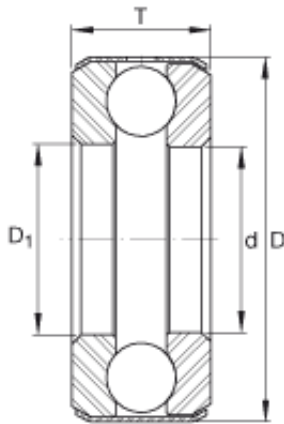

Bearing Argentina, S.A.



RE40035UUC0P5S Crossed Roller Bearing 400x480x35mm

Bearing No. B23

B23 Bearing 2D drawings and 3D CAD models

Size	47.625x81.76x22.22 mm
Bore Diameter	47,625 mm
Outer Diameter	81,76 mm
Width	22,22 mm
d	1 7/8 inch
d	47,625 mm
D	3,219 inch
D	81,76 mm
T	0,875 inch
T	22,22 mm
D ₁	1,906 inch
m	0,968 lbs / Weight
m	0,439 kg / Weight
C _a	13200 lbf / Dynamic load rating (axial)
C _a	58700 N / Dynamic load rating (axial)
C _{0a}	31000 lbf / Static load rating (axial)
C _{0a}	138000 N / Static load rating (axial)
Category	Thrust Ball Bearing
Inventory	0.0
Manufacturer Name	SCHAEFFLER GROUP
Minimum Buy Quantity	N/A
Weight / Kilogram	0.525
Product Group	B00308



Bearing Argentina, S.A.

Rolling Element	Ball Bearing
Thrust Bearing	Yes
Single or Double Direction	Single Direction
Banded	Yes
Cage Material	Steel
Precision Class	ABEC 1 ISO P0
Component Description	Roller Assembly Plus Raceways
Other Features	Single Row With Flat Seat
Long Description	1-7/8" Bore 1; 1-29/32" Bore 2; 3-7/32" Outside Diameter; 7/8" Height; Ball Bearing; Single Direction; Banded; Steel Cage; ABEC 1 ISO P0 Precision
Inch - Metric	Inch
Category	Thrust Ball Bearings
UNSPSC	31171552
Harmonized Tariff Code	8482.10.50.08
Noun	Bearing
Keyword String	Ball Thrust
Manufacturer URL	http://www.ina.com
Height	0.875 Inch 22.225 Millimeter
Outside Diameter	3.219 Inch 81.763 Millimeter
Bore 2	1.906 Inch 48.412 Millimeter
Bore 1	1.875 Inch 47.625 Millimeter
Overall Height with Aligning Washer	0 Inch 0 Millimeter